

ISYMETRE

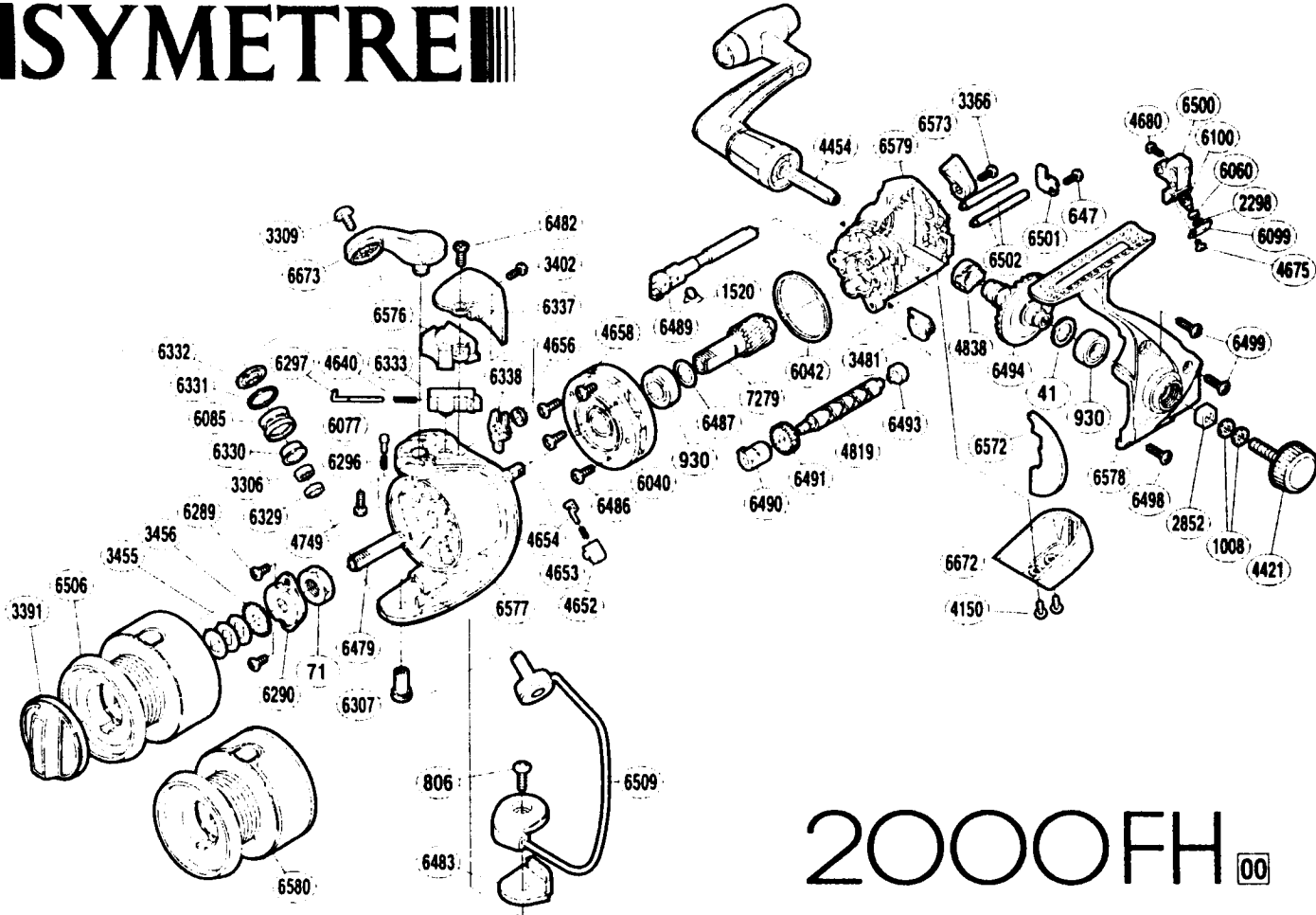

2000FH 00

RD No.	PARTS NAMES	RD No.	PARTS NAMES	RD No.	PARTS NAMES
0041	Drive Gear Washer	4675	Oscillating Pawl Cover Screw	6483	Bail Hold Support Spacer
0071	Rotor Nut	4680	Slider Retainer Screw	6486	Roller Clutch Screw
0647	Worm Shaft Retainer Screw	4749	Bail Arm Screw	6487	Adjusting Washer
0806	Bail Hold Support Screw	4819	Worm Shaft	6489	Anti-Reverse Cam
0930	Ball Bearing	4838	Drive Gear Bushing	6490	Worm Bushing (front)
1008	Handle Lock Washer	6040	Roller Clutch Assembly	6491	Idle Gear
1520	Anti-Reverse Cam Spring	6042	Friction Ring	6493	Worm Bushing (rear)
2298	Spacer	6060	Oscillating Slider Bushing	6494	Drive Gear
2852	Handle Screw Lock	6077	Click Pin	6498	Side Cover Screw (short)
3306	Ball Bearing	6085	Line Roller	6499	Side Cover Screw (long)
3309	Line Roller Screw	6099	Oscillating Pawl Cover	6500	Oscillating Slider
3366	Anti-Reverse Lever Screw	6100	Oscillating Pawl	6501	Worm Shaft Retainer
3391	Drag Knob	6289	Nut Lock Screw	6502	Oscillating Guide
3402	Protector Screw (small)	6290	Rotor Nut Lock Plate	6506	Spool Assembly (aluminum)
3455	Spool Washer	6296	Click Spring	6509	Bail Assembly
3456	Spool Support	6297	Bail Spring Guide (A)	6572	Side Cover Flange
3481	Bushing	6307	Bail Hold Support Shaft	6573	Anti-Reverse Lever
4150	Rear Protector Screw	6329	Bearing Spacer	6576	Bail Spring Cover
4421	Handle Screw Cap	6330	Line Roller Bushing	6577	Rotor
4454	Handle Assembly	6331	Line Roller Spacer	6578	Side Cover
4640	Bail Spring	6332	Line Roller Washer	6579	Body
4652	Lever Spring Guide (B)	6333	Bail Spring Guide (B)	6580	Spool Assembly (graphite)
4653	Lever Spring	6337	Rotor Protector	6672	Rear Protector
4654	Lever Spring Guide (A)	6338	Bail Trip Lever	6673	Bail Arm
4656	Trip Lever Spacer	6479	Main Shaft	7279	Pinion Gear
4658	Clutch Cover Screw	6482	Protector Screw (large)		