

# SHIMANO®

## 1992 REPAIR MANUAL

Shimano American Corporation, One Shimano Dr.  
Irvine, CA 92718

※Please check this eared part of the "Dial Case"  
here to see whether you have old or new-type reel.

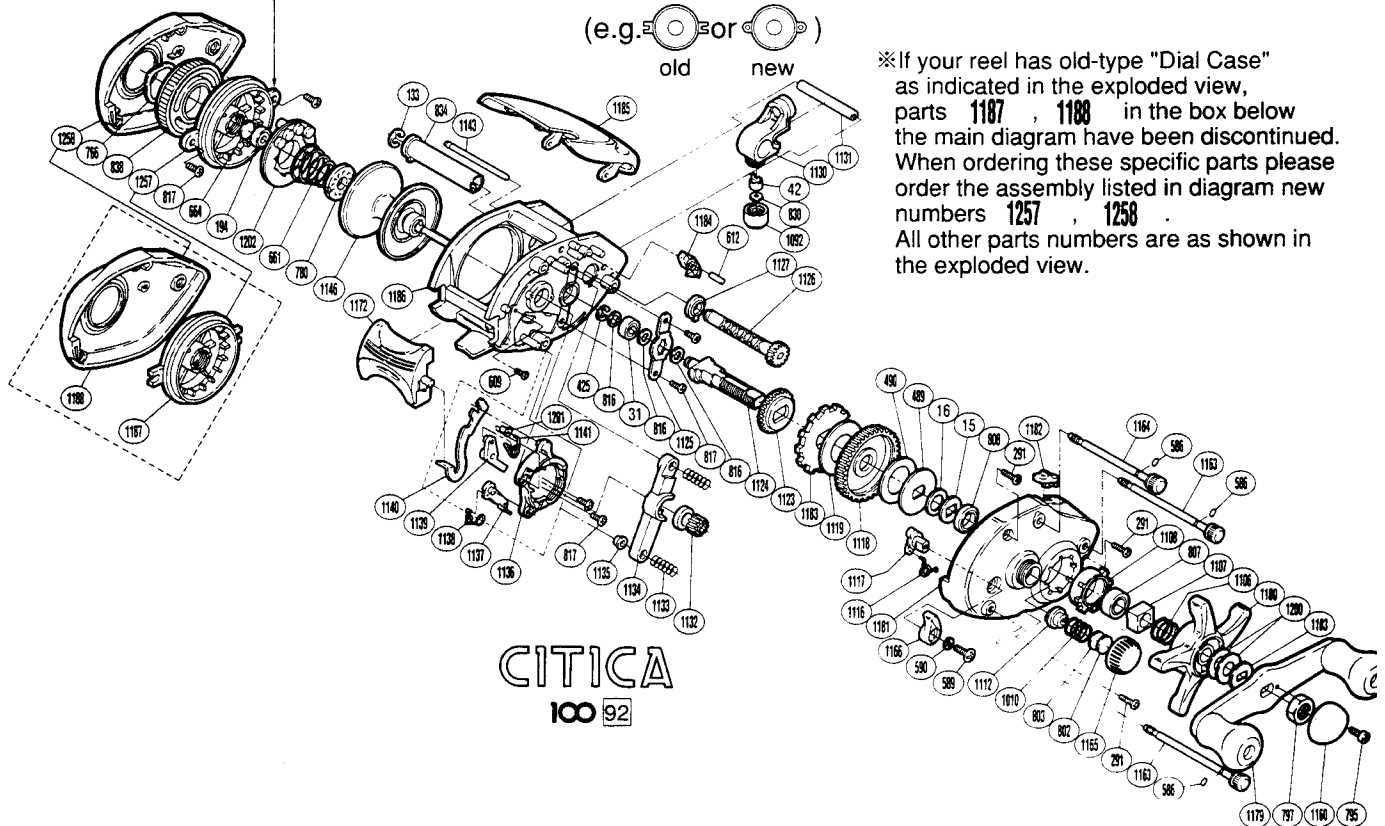

※If your reel has old-type "Dial Case" as indicated in the exploded view, parts 1187, 1188 in the box below the main diagram have been discontinued. When ordering these specific parts please order the assembly listed in diagram new numbers 1257, 1258. All other parts numbers are as shown in the exploded view.

BNT No.	PARTS NAMES	BNT No.	PARTS NAMES	BNT No.	PARTS NAMES
0015	Drag Spring Washer	1010	Spool Tension Spring	1160	Handle Nut Cover
0016	Friction Washer (C)	1092	Pawl Cap	1163	Side Plate Bolt (A)
0031	Drive Shaft Bearing (A)	1103	Friction Washer (A)	1164	Side Plate Bolt (B)
0042	Line Guide Pawl	1106	Star Drag Spring	1165	Cast Control Cap
0133	Worm Shaft Retainer	1107	Star Drag Nut	1166	Flipping Lever
0194	Ball Bearing	1108	Bearing Holder	1172	Quick-Fire II Clutch Bar
0291	Right Side Plate Screw	1112	Spool Shaft Bushing	1179	Handle Assembly
0425	Drive Shaft Lock	1116	Cam Spring	1180	Star Drag
0489	Key Washer (A)	1117	Flipping Cam	1181	Right Side Plate
0490	Drag Washer (B)	1118	Drive Gear	1182	Anti-Reverse Switch
0586	Bolt Retainer	1119	Drag Washer (A)	1183	Anti-Reverse Ratchet
0589	Flipping Lever Screw	1123	Idle Gear	1184	Anti-Reverse Pawl
0590	Lock Washer	1124	Drive Shaft	1185	Thumb Rest
0609	Clutch Plate Retainer Screw	1125	Drive Shaft Retainer	1186	One-Piece Frame
0612	Anti-Reverse Pawl Pin	1126	Worm Shaft	1200	Star Drag Spacer
0661	Magnet Retainer Spring	1127	Worm Bearing	1201	Retractor Spring Collar
0664	Spacer (B)	1130	Line Guide	1202	Magnet Retainer
0766	Dial Friction Washer	1131	Stabilizer Bar	1257	Dial Case
0780	Magnet Retainer Lock	1132	Pinion Gear	1258	Left Side Plate
0795	Handle Nut Cover Screw	1133	Yoke Spring		
0797	Handle Nut	1134	Yoke		
0802	Spool Tension Spacer (B)	1135	Yoke Spacer		
0803	Spool Tension Spacer (A)	1136	Clutch Cam		
0807	Drive Shaft Bearing (B)	1137	Clutch Pawl		
0808	Friction Washer (B)	1138	Clutch Pawl Spring		
0816	Drive Shaft Washer	1139	Joint Plate		
0817	Multi Purpose Screw	1140	Clutch Plate		
0830	Spacer (optional)	1141	Retractor Spring		
0834	Level Wind Guard	1143	Thumb Rest Support	1187	Dial Case
0838	Magnetic Control Dial	1146	Spool Assembly	1188	Left Side Plate