

# CALCUTTA

## 50 <sup>96</sup>

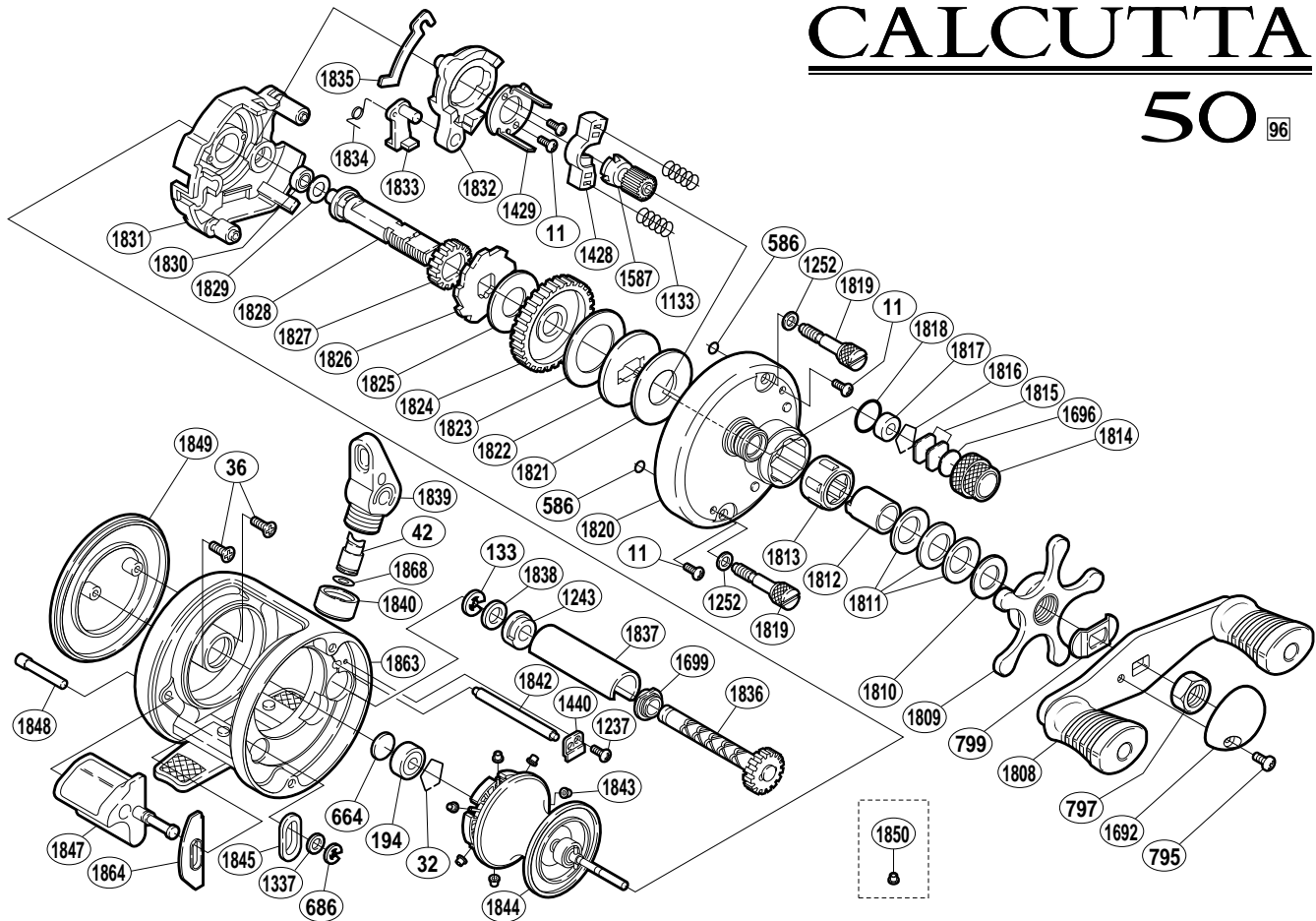

1997-10-7

BNT No.	PARTS NAMES	BNT No.	PARTS NAMES	BNT No.	PARTS NAMES
0011	Multi-Purpose Screw	1808	Handle Assembly	1832	Clutch Cam
0032	Bearing Retainer	1809	Star Drag	1833	Clutch Pawl
0036	Left Side Plate Screw	1810	Star Drag Spacer	1834	Clutch Pawl Spring
0042	Line Guide Pawl	1811	Coned Disc Spring	1835	Clutch Plate
0133	Worm Shaft Retainer	1812	Roller Clutch Inner Tube	1836	Worm Shaft
0194	Ball Bearing	1813	Roller Clutch Bearing	1837	Level Wind Guard
0586	Bolt Retainer	1814	Cast Control Cap	1838	Worm Shaft Spacer
0664	Spacer (B)	1815	Spool Tension Spacer	1839	Line Guide
0686	"E" Lock	1816	Bearing Retainer	1840	Pawl Cap
0795	Handle Nut Plate Screw	1817	Spool Shaft Bushing	1842	Level Wind Guide
0797	Handle Nut	1818	"O" Ring	1843	Brake Collar (blue)
0799	Friction Washer	1819	Right Side Plate Bolt	1844	Spool Assembly
1133	Yoke Spring	1820	Right Side Plate	1845	Clutch Bar Guide (A)
1237	Worm Bushing (A) Retainer Screw	1821	Drag Washer (D)	1847	Quick-Fire II Clutch Bar
1243	Worm Bushing (B)	1822	Key Washer (A-2)	1848	Clutch Bar Support
1252	Right Side Plate Bolt Washer	1823	Drag Washer (A-2)	1849	Left Side Plate
1337	Clutch Bar Support Spacer	1824	Drive Gear	1863	Forged One-Piece Frame
1428	Yoke	1825	Drag Washer (A-1)	1864	Clutch Bar Guide (B)
1429	Clutch Cam Retainer	1826	Anti-Reverse Ratchet	1868	Spacer
1440	Worm Bushing (A) Retainer	1827	Idle Gear (A)		
1587	Pinion Gear	1828	Drive Shaft		
1692	Handle Nut Plate	1829	Drive Shaft Spacer		
1696	Cast Control Spacer (B)	1830	Ball Bearing	1850	Brake Collar (yellow)
1699	Worm Bushing (A)	1831	Set Plate		

(080202)