

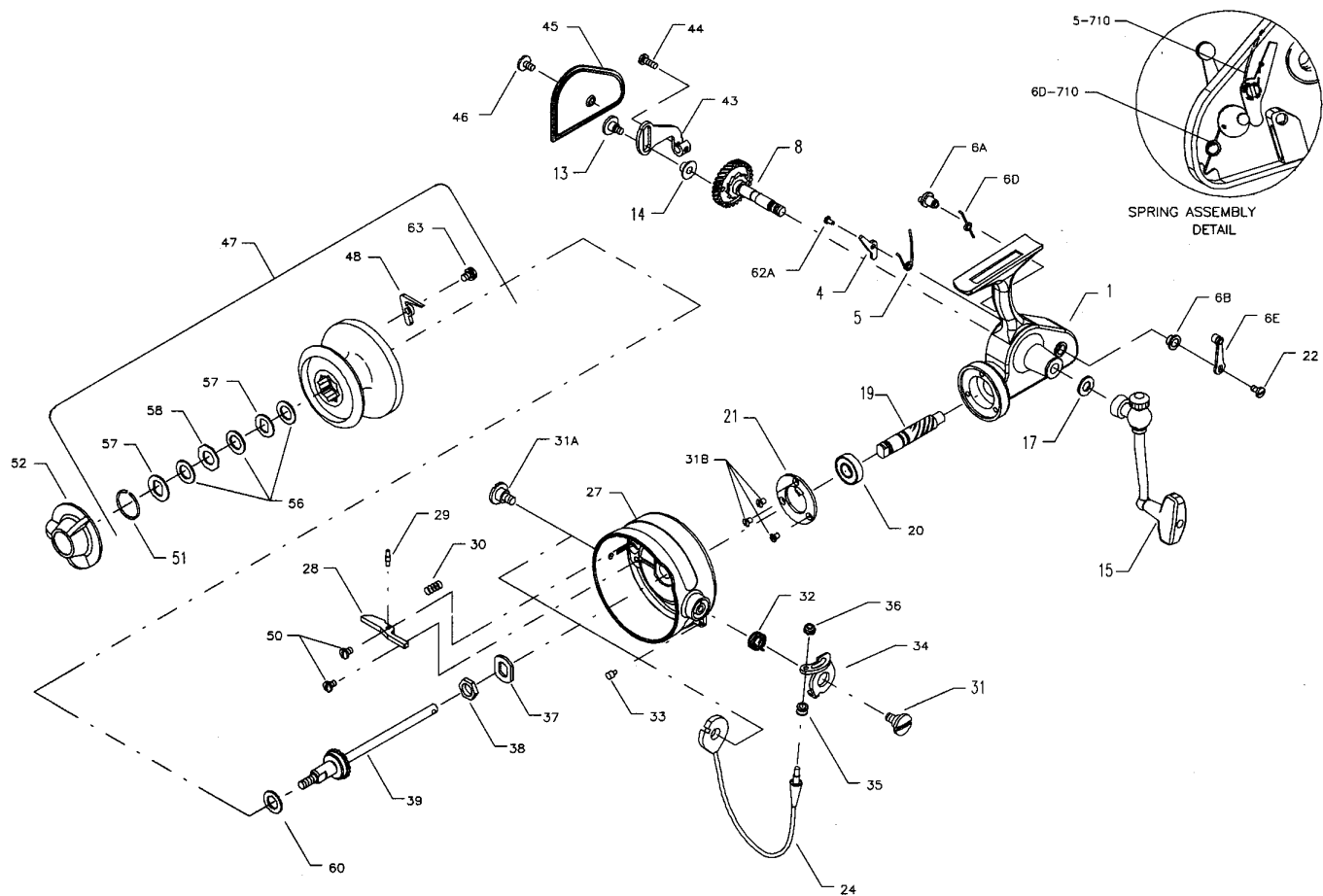

## PARTS LIST FOR MODELS 712Z AND 713Z



KEY NO.	DESCRIPTION	PART NO.	KEY NO.	DESCRIPTION	PART NO.
1	Housing w/Bushing	*710Z	32	Bail Spring	32-710
4	Dog	4-710	33	Bail Arm Bumper	33R-712
5	Dog Spring	*5-710	34	Bail Arm	34-712
6A	Eccentric	*6A-710	35	Line Roller	35-720
6B	Eccentric Liner	6B-700Z	36	Bail Lock Nut	36-700
6D	Eccentric Spring	6D-710	37	Rotor Cup Washer	37-710
6E	Eccentric Lever	6E-710	38	Rotor Cup Nut	38-710
8	Main Gear w/Ratchet	*8-712	39	Spool Shaft	39-712
13	Crosswind Screw	13-710	43	Crosswind Arm	*43-710
14	Crosswind Roller	14-710	44	Crosswind Screw	44-710
15	Handle (Complete)	*15-712Z	45	Housing Plate	*45-712Z
17	Handle Washer	17-710	46	Housing Plate Screw	46-710
19	Pinion Gear	19-712	47	Spool (Complete)	47-712Z
20	Pinion Bearing	20-704	48	Click Tongue	48-720
21	Bearing Retainer	21-712	50	Release Arm Screw (2 req.)	50-712
22	Eccentric Screw	22-109	51	Retaining Spring	51-710
24	Bail Wire	24-712	52	Drag Knob	52-710Z
27	Rotor Cup	27-712Z	56	Drag Washer-HT-100 (3 req.)	56-710
28	Bail Release Arm	28-712	57	Metal Keyed Washer (2 req.)	57-720
29	Bail Release Pin	29-712	58	Metal Washer (Octagon)	58-720
30	Bail Release Spring	30-700	60	Rear Drag Washer (Teflon®)	60-712
31	Bail Arm Screw	31-710	62A	Dog Screw	62A-716
31A	Bail Screw	31A-712	63	Click Screw	63-349
31B	Bail Cover Screw (3 req.)	31-19			

\*For 713Z model order these parts with model suffix (i.e. 1-713Z Housing with Bushing)