

Garcia

MITCHELL 486-487

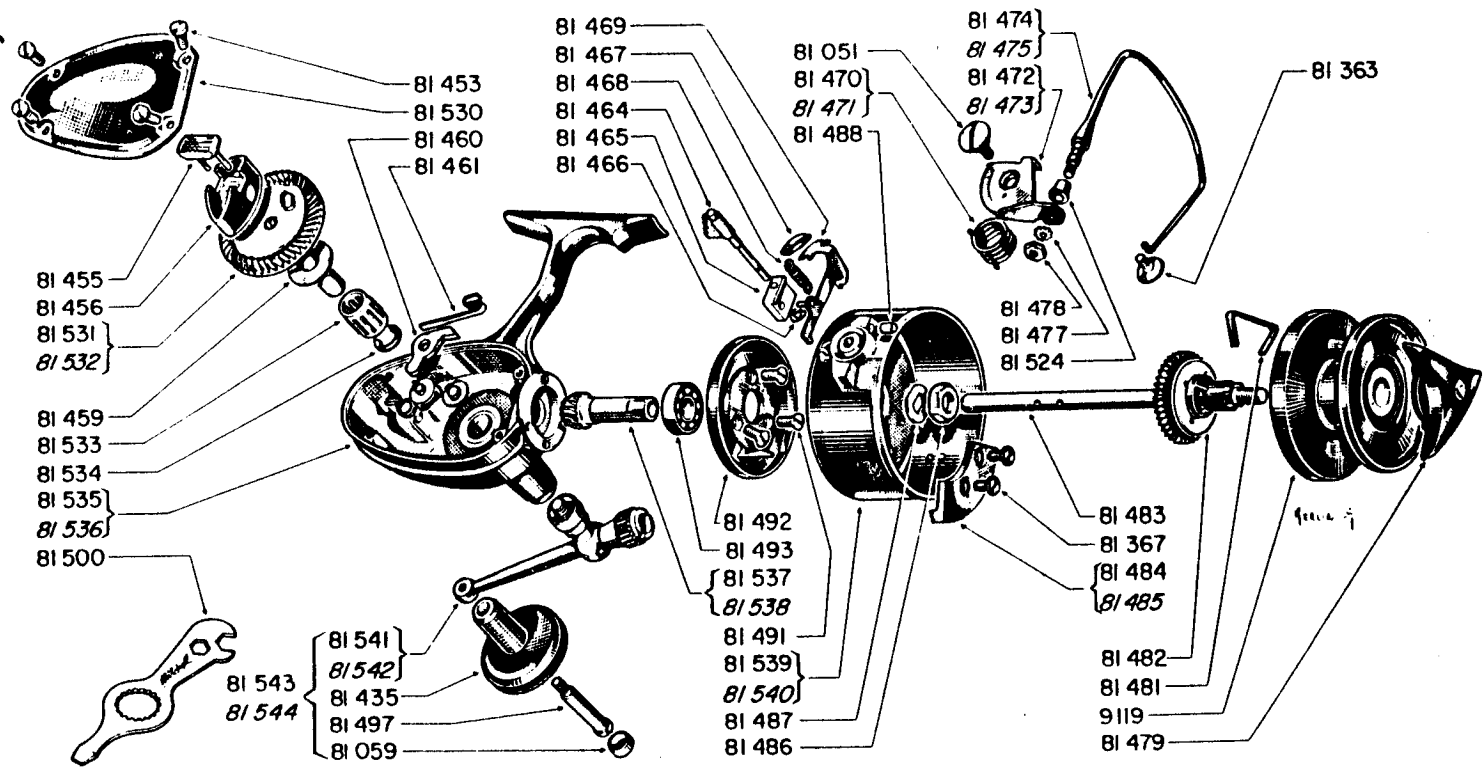

Items in red for left hand model 487

Prices subject to change without notice.

Please specify both reel model and part numbers when ordering.

| No. | Part Name | Price | No. | Part Name | Price | No. | Part Name | Price |
|-------|-------------------------|-----------|-------|-------------------------------|-----------|-------|-----------------------|-------|
| 8119 | Spool, Standard | 4.50 | 81471 | Bail Spring (487) | .15 | 81497 | Handle Knob Screw | .50 |
| 81051 | Bail Screw No. 1 | .20 | 81472 | Bail Wire Mount (486) | 1.50 | 81500 | Utility Tool | .40 |
| 81059 | Knob Lube Port | .10 | 81473 | Bail Wire Mount (487) | 1.50 | 81524 | Roller Line Guide | 2.25 |
| 81363 | Bail Screw No. 2 | .25 | 81474 | Bail Wire (486) | 2.75 | 81530 | Side Plate | .75 |
| 81367 | Counterweight Screw | (ea.) .10 | 81475 | Bail Wire (487) | 2.75 | 81531 | Drive Gear (486) | 5.25 |
| 81435 | Handle Knob | 1.00 | 81477 | Bail Wire Lock Washer | .10 | 81532 | Drive Gear (487) | 5.25 |
| 81453 | Side Plate Screw | (ea.) .10 | 81478 | Bail Wire Lock Nut | .25 | 81533 | Drive Gear Bearing | 1.25 |
| 81455 | Oscillation Slide Lock | .30 | 81479 | Drag Adjusting Knob | 2.00 | 81534 | Bearing "C" Lock | .10 |
| 81456 | Oscillation Slide | .50 | 81481 | Click Spring | .25 | 81535 | Housing (486) | 8.25 |
| 81459 | Thrust Washer | .10 | 81482 | Ferodo Drag Plate | 1.00 | 81536 | Housing (487) | 8.25 |
| 81460 | Anti Reverse Dog | .20 | 81483 | Axle, with Ratchet | 2.00 | 81537 | Pinion Gear (486) | 2.25 |
| 81461 | Anti Reverse Dog Spring | .10 | 81484 | Counterweight (486) | .60 | 81538 | Pinion Gear (487) | 2.25 |
| 81464 | Bail Trip Shaft | .75 | 81485 | Counterweight (487) | .60 | 81539 | Rotating Head (486) | 5.00 |
| 81465 | Bail Trip Cam | .10 | 81486 | Hex Nut | .20 | 81540 | Rotating Head (487) | 5.00 |
| 81466 | Cam "C" Lock | .10 | 81487 | Keyed Washer | .15 | 81541 | Handle Shank (486) | 3.75 |
| 81467 | Anti Inertia Brake | .15 | 81488 | Bail Bumper | .10 | 81542 | Handle Shank (487) | 3.75 |
| 81468 | Trip Lever Spring | .20 | 81491 | Brake Drum Screw | (ea.) .10 | 81543 | Handle Complete (486) | 5.25 |
| 81469 | Trip Lever | .50 | 81492 | Brake Drum | .75 | 81542 | Handle Complete (487) | 5.25 |
| 81470 | Bail Spring (486) | .15 | 81493 | Ball Bearing, Stainless Steel | 4.50 | | | |

PARTS AND SERVICE AVAILABLE AT THE FOLLOWING REGIONAL FACTORY REPAIR DEPOTS:

**FACTORY SERVICE
RODS, REELS AND PARTS**

**THE GARCIA SERVICE DEPARTMENT
329 ALFRED AVENUE
TEANECK, NEW JERSEY 07666**

**THE CONOLON CORPORATION
1111 EAST McFADDEN STREET
SANTA ANA, CALIFORNIA 92705**

**SILICOTE SALES DIVISION
520 WEST 14th AVENUE
OSHKOSH, WISCONSIN 54902**

**J. K. CLARK COMPANY
ACD SPORTSMEN SERVICE
13501 VAN DYKE
DETROIT, MICHIGAN 48234**

REEL SERVICE AND PARTS

**NATE BUELL SERVICE CORPORATION
5013 N.E. 42nd STREET
PORTLAND, OREGON 97218**

**HARRY C. MILLER CO., INC.
257 PARK AVENUE SOUTH
NEW YORK, NEW YORK 10010**

**SHERMAN LOYD SALES COMPANY
4737 GREENVILLE AVENUE
DALLAS, TEXAS 75208**