

208S

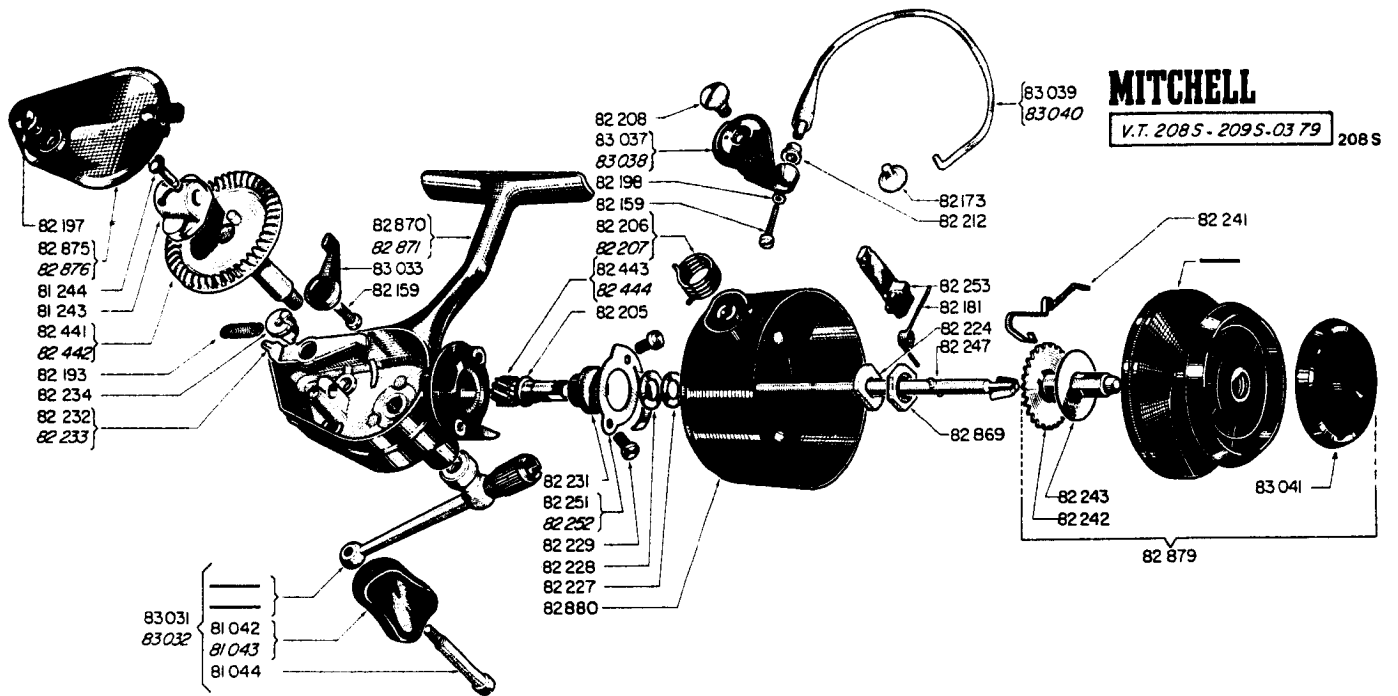

CODE NO.	DESCRIPTION	SUGGESTED RETAIL	CODE NO.	DESCRIPTION	SUGGESTED RETAIL
81042	Handle Knob	.60	82252	Anti Inertia Brake	1.20
81043	Handle Knob	.60	82253	Bail Trip	.65
81044	Handle Knob Screw	.60	82260	Bail Wire Mount	2.85
81241	Drive Gear	2.40	82261	Bail Wire Mount	2.85
81243	Oscillation Slide	.40	82441	Drive Gear	7.30
81244	Oscillation Slide Lock	.25	82442	Drive Gear	7.30
82159	Anti Reverse Lever Screw	.40	82443	Pinion Gear	1.85
82173	Bail Screw N 2	.45	82444	Pinion Gear	1.85
82181	Bail Trip Spring	.25	82869	Hex Nut	.45
*82189	Handle Complete	2.65	82870	Housing	9.80
*82190	Handle Complete	2.50	82871	Housing	9.80
82193	Anti Reverse Spring	.25	82875	Cover Plate	2.10
82197	Side Plate Screw	.40	82876	Cover Plate	2.10
82198	Bail Wire Lock Washer	.25	82879	Spool Complete	4.25
82201	Anti Reverse Lever	.65	82880	Rotating Head	3.85
82205	Thrust Washer R	.25			
82206	Bail Spring	.40			
82207	Bail Spring	.40			
82208	Bail Screw N 1	.60			
82212	Line Guide	.85			
82224	Keyed Washer	.25			
82227	Rotating Head Washer	.25			
82228	Shims to Adjust Head/ Pinion Gear	.25			
82229	Bushing Lock Screw	.25			
82231	Bushing	1.05			
82232	Anti Reverse Dog	1.10			
82233	Anti Reverse Dog	1.10			
82234	Anti Reverse Cam	.45			
82239	Bail Wire	5.90			
82240	Bail Wire	5.90			
82242	Spindle	3.05			
82243	Drag Washer	.80			
82245	Drag Adjusting Knob	.60			
82247	Axle	2.05			
82251	Anti Inertia Brake	1.20			

*When present inventory is depleted, this part will be replaced by another number. Please refer to chart in back of book